



Victor Buyck Steel Construction

High Rise Steelwork Experience



Victor Buyck Steel Construction

HIGH RISE STRUCTURES IN LONDON

The City of London

Exchange House	Broadgate Development	7,000	tonne
59 - 67 Gresham Street		4,000	tonne
Swiss Re		10,500	tonne

Canary Wharf Development

Building FC1	Credit Suisse Group	6,000	tonne
Building FC2	Ogilvy & Mather - Barclays Capital	7,000	tonne
Building FC5	Morgan Stanley Dean Witter	5,500	tonne
Building FC6	London Underground	3,500	tonne
Building DS5	Citigroup	12,000	tonne
Building HQ4	Northern Trust	2,500	tonne
Building HQ2	Lehman Brothers	12,500	tonne
Building BP1	Barclays	10,000	tonne
Building BP3		3,500	tonne
Building BP2		4,500	tonne

Total in London

88,500 tonne



Victor Buyck Steel Construction

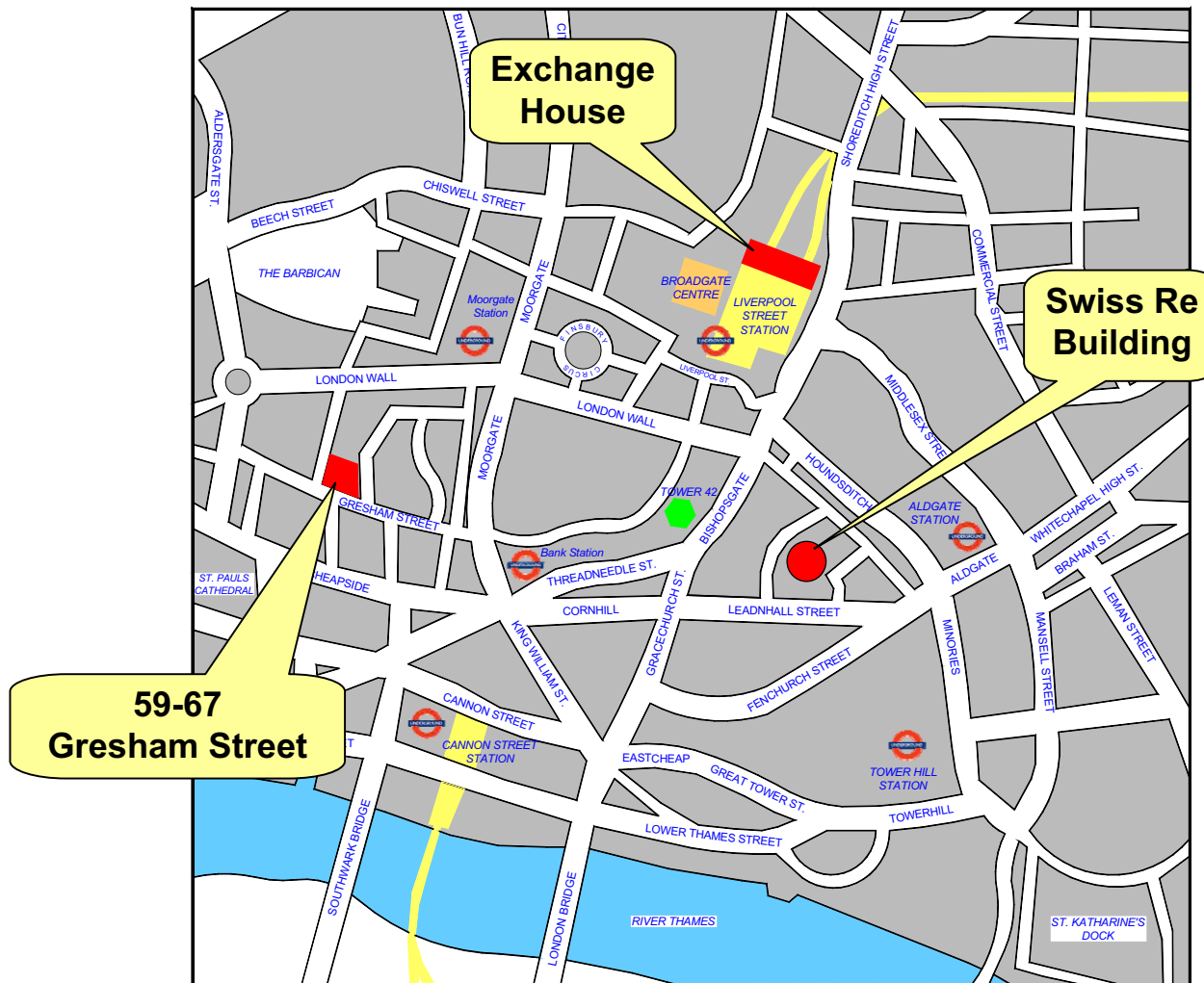



Victor Buyck Steel Construction



Site Visit

Exchange House

12th October 2007



Victor Buyck Steel Construction



Site Visit

Swiss Re

12th October 2007



Victor Buyck Steel Construction



Site Visit

Swiss Re

12th October 2007



Victor Buyck Steel Construction

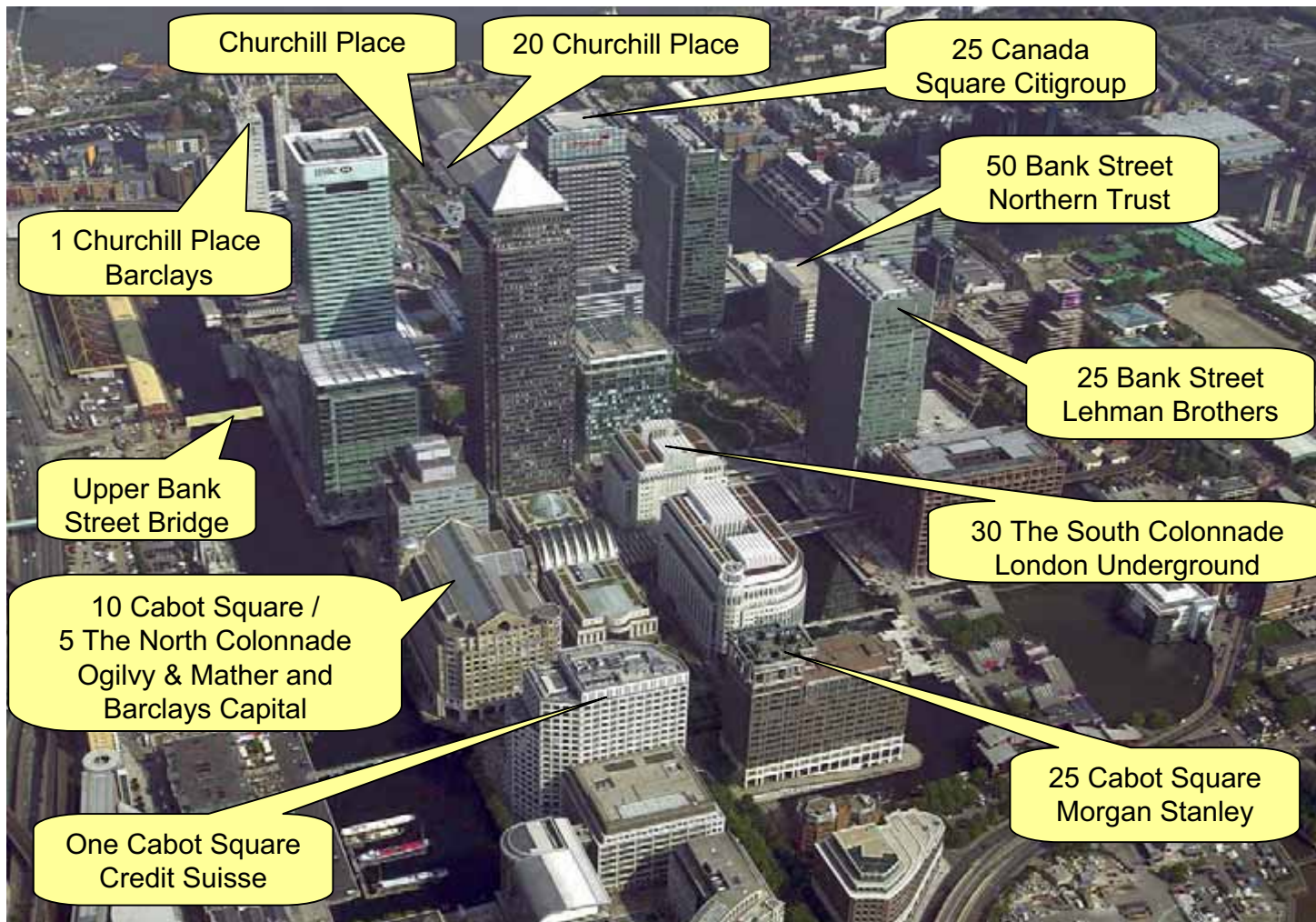



Victor Buyck Steel Construction



Site Visit

Great Wharf Road Bridge

12th October 2007



Victor Buyck Steel Construction



Site Visit

Citigroup at Canary Wharf

12th October 2007



Victor Buyck Steel Construction



Site Visit

Barclays Canary Wharf

12th October 2007



Victor Buyck Steel Construction

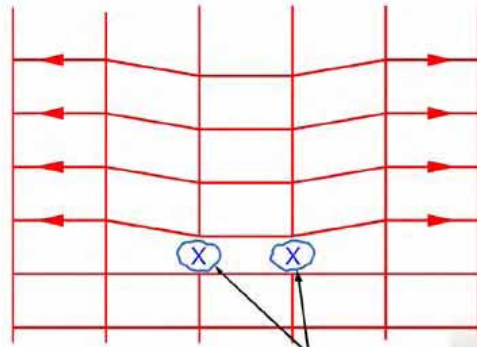

Two Columns removed by an extreme event

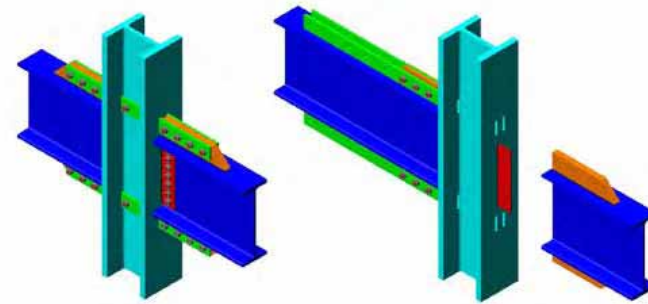

Patent "EXTREME EVENT BEAM LINK" detail

- SIMPLE ERECTION ON SHEAR TABS
- BEAM LINKS INSERTED LATER AND OFF CRITICAL PATH



Extreme Event Beam Link



Victor Buyck Steel Construction

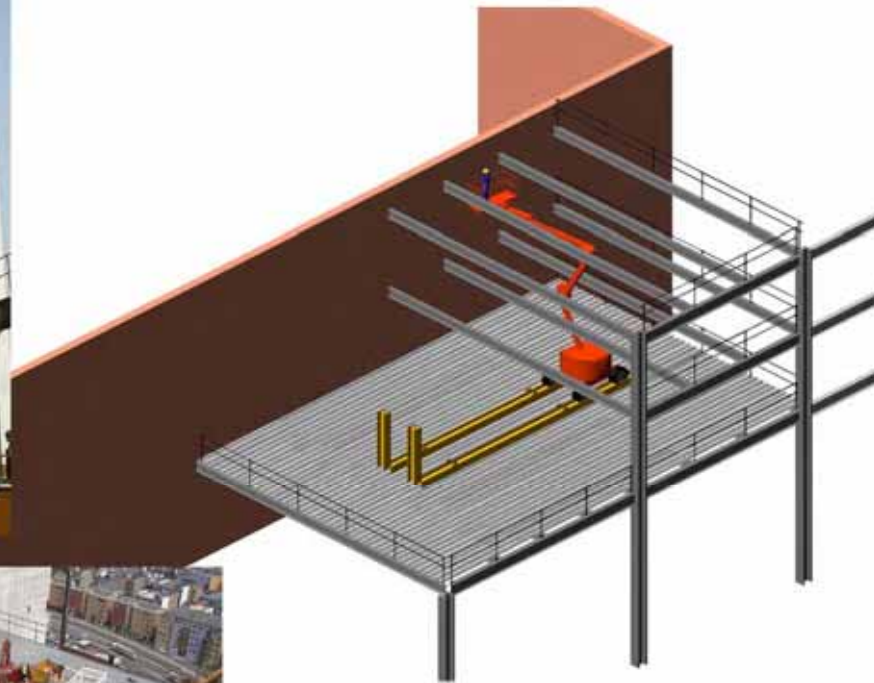

**CHERRY PICKER WORKING WITHIN
FULLY EDGE PROTECTED CORRAL**

Erectors do not work on the open steel

Site Visit

Safe Erection

12th October 2007



Victor Buyck Steel Construction



Site Visit

Canary Wharf Building BP3

12th October 2007



Victor Buyck Steel Construction



Site Visit

Canary Wharf Building BP2

12th October 2007



Victor Buyck Steel Construction

Luxembourg



High Wycombe - UK



Gent - Belgium





Victor Buyck Steel Construction

HIGH RISE STRUCTURES IN SOUTH EAST ASIA

Kuala Lumpur – Malaysia

421m high Telecommunications Tower

Tower Head & Antenna Mast 1,800 tonne

Suria KLCC Retail Podium 18,000 tonne

Malaysia Telecom Headquarters

77 Storey - 378m high – levels 56 to 77 1,000 tonne



Victor Buyck Steel Construction

Telecommunications Tower

Kuala Lumpur – Malaysia

1,800 tonnes

Height 421m

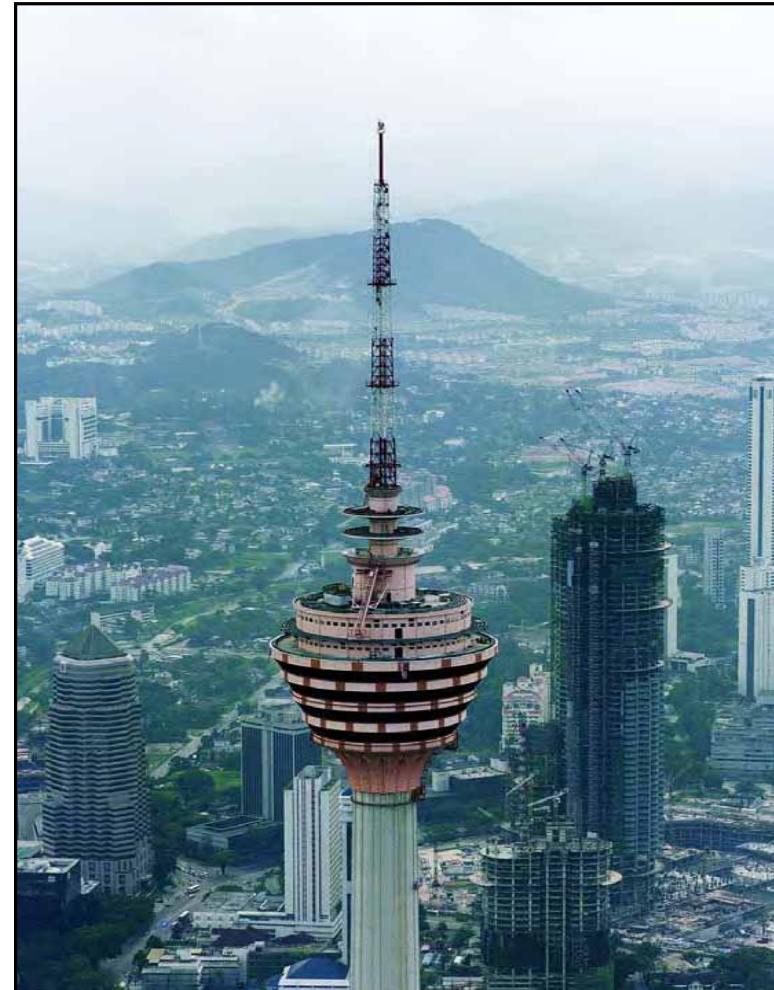



Victor Buyck Steel Construction

Malaysia Telecom Headquarters

Height 378m



Site Visit

12th October 2007



Victor Buyck Steel Construction

Suria KLCC Retail Centre
Kuala Lumpur – Malaysia
18,000 tonnes



Site Visit

12th October 2007



Victor Buyck Steel Construction

- 250m long tree
- Half inside the concourse
- Tree trunk as much as 5m diameter
- Free form branches
- Flat concrete roof

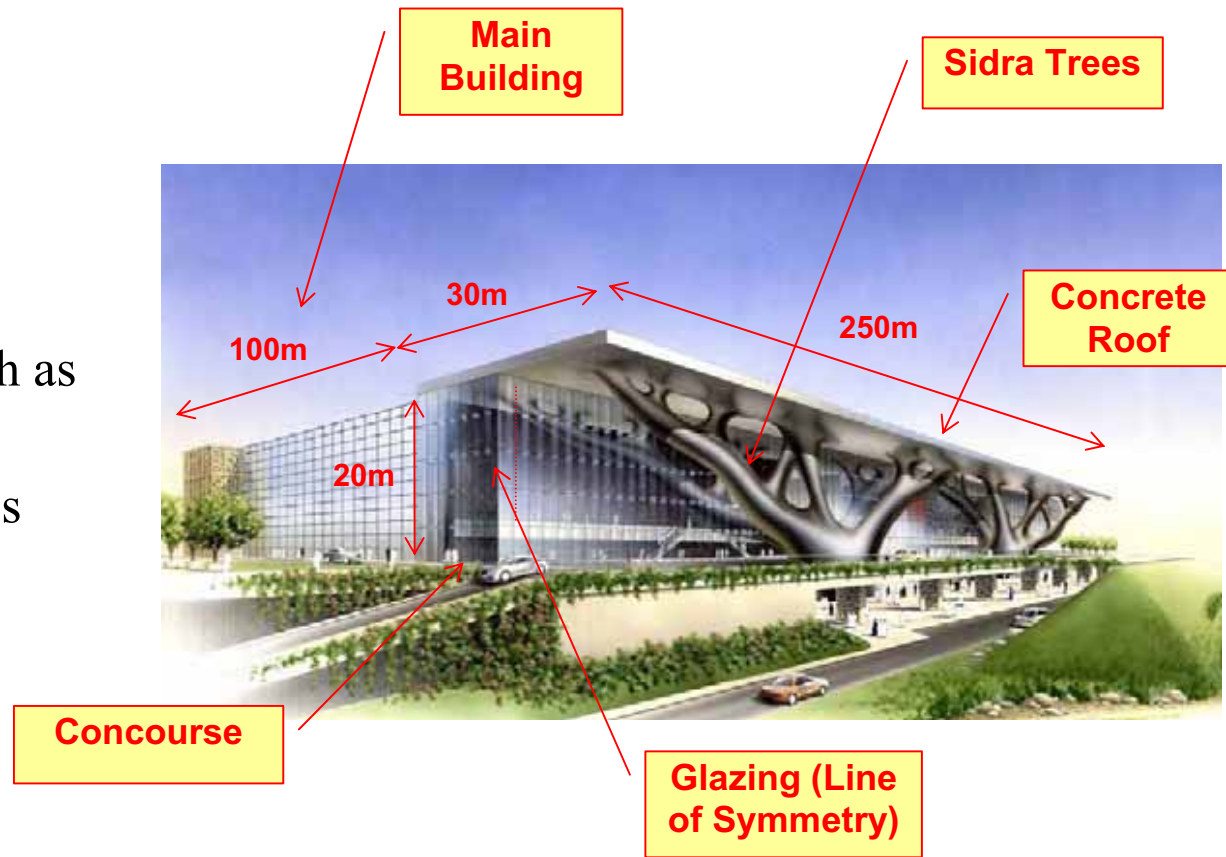

Sidra Trees – Convention Centre – Doha - Qatar



Victor Buyck Steel Construction

- Free-form geometry of the tree surface
- Over 60,000 kN tension in the roof (working load)
- 625 mm pre-camber at roof corner
- Prefabrication and transportability

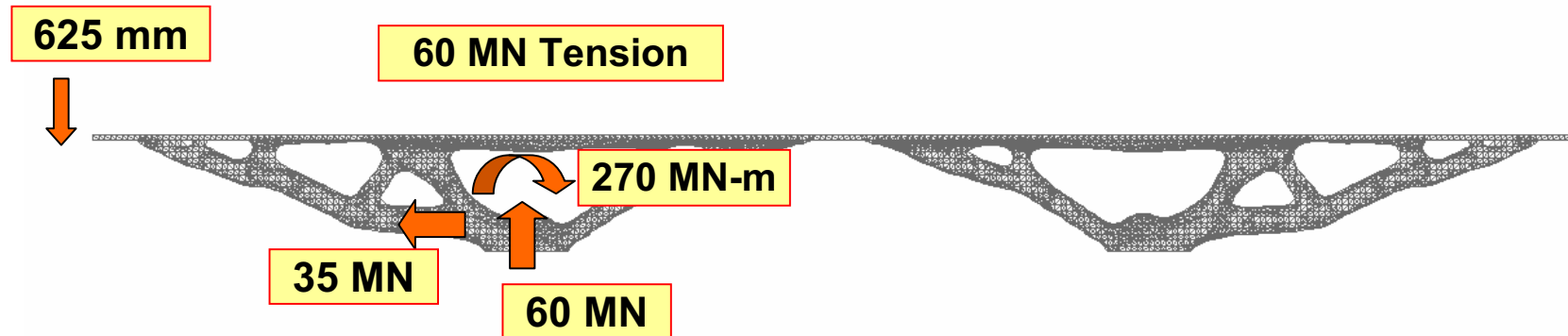

Overview – the challenges



Victor Buyck Steel Construction

CANARY WHARF TYPICAL BUILDING LAYOUT

- Concrete core
- Steel frame perimeter
- 9m perimeter column spacing
- 3m secondary beam spacing
- 13.5m secondary beam span
- 4.15m floor to floor height



Victor Buyck Steel Construction

CANARY WHARF

Canary Wharf Standard

- Concrete core
- Steel frame perimeter
- Enhanced frame robustness (Since BP1)
- 9m perimeter column spacing
- 3m secondary beam spacing
- 13.5m secondary beam span
- Standard rolled beams
- 4.15m floor to floor height

Building BP3 Compared to Standard

- Yes
- Yes
- Yes – Non standard details
- Yes
- Yes
- Yes
- No - Beams with penetrations
- No – Reduced to 3.95m

Compare BP3 to Canary Wharf Standard



Victor Buyck Steel Construction

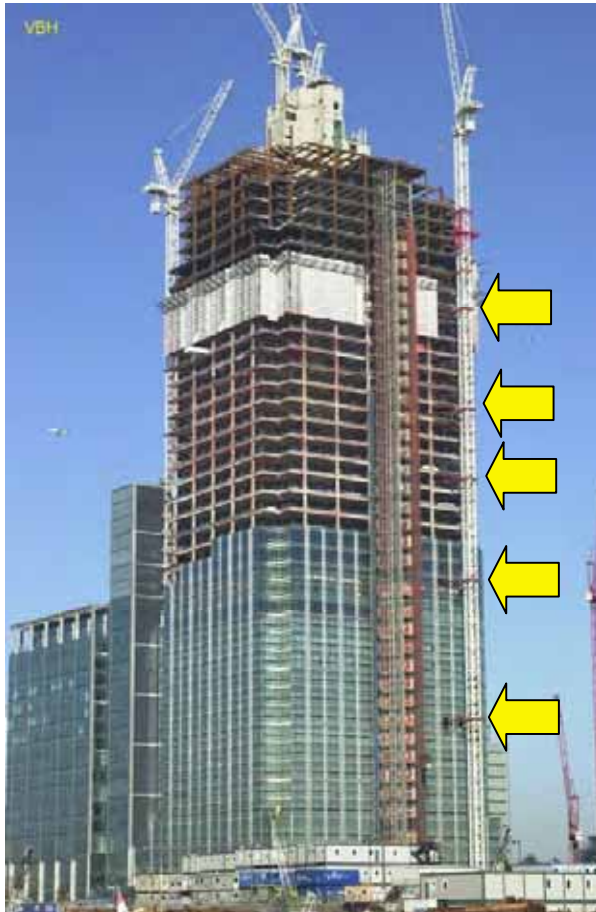

Crane
Ties

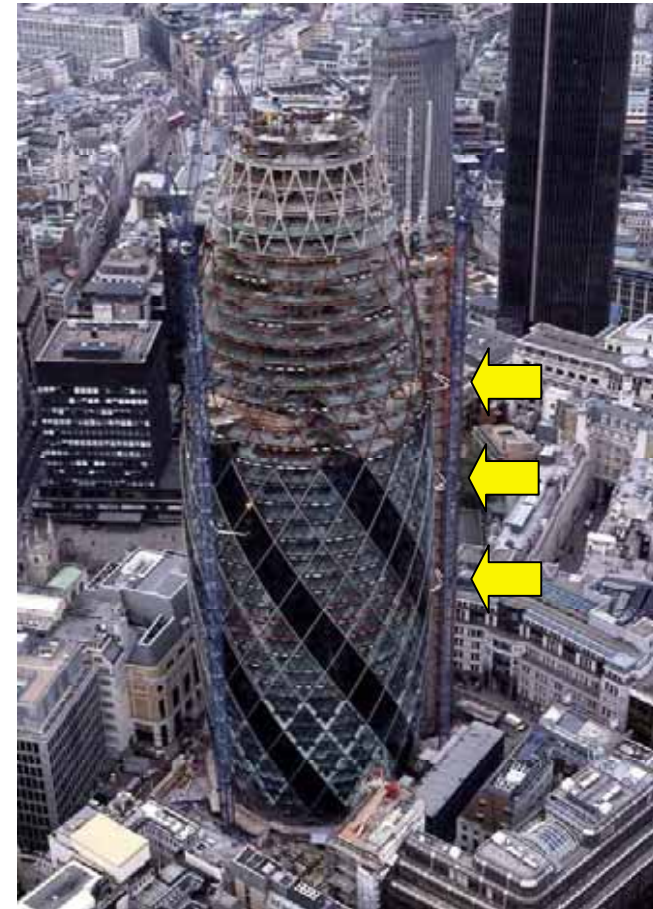

Canary Wharf Building DS5

Swiss Re



Victor Buyck Steel Construction



Canary Wharf Building BP1
Cranes on top of Cores



Victor Buyck Steel Construction



Site Visit

The Pinnacle

12th October 2007



Victor Buyck Steel Construction



Site Visit

Shard at London Bridge

12th October 2007